



CLADDING

APPLICATIONS

Out houses • Garages
Screens & partitions
Changing rooms
Animal housing



The Ariel Cladding System of PVC sheets and fixing accessories, is suitable for wall and ceiling cladding. Lightweight and easy to install, the sheets have a class 1 fire rating and are suitable for a range of applications. Available in white, with a matt, satin or gloss surface finish, they provide a super-tough,

non-absorbent finish that is impervious to dirt and grime. They can be easily cleaned so can be used

Foam PVC Sheets are made from an extruded, closed cell, unplasticised PVC foam. to provide a hygienic area for food preparation. However, the cladding sheets are not food-grade so

cannot be used for direct contact

with food.

Sheet Sizes

CODE	DESCRIPTION	FINISH	SHEET THICKNESS	SHEET SIZE	WEIGHT
67003	Standard Cladding Sheet - Foam PVC	Matt	3mm	610mm X 1220mm	1.078 KG
68004	Standard Cladding Sheet - Foam PVC	Matt	3mm	1220mm X 1220mm	2.053 KG
67008	Standard Cladding Sheet - Foam PVC	Matt	3mm	1220mm X 2440mm	4.243 KG
68006	Premium Cladding Sheet - Foam PVC	Gloss	3mm	610mm X 1220mm	1.061 KG
68007	Premium Cladding Sheet - Foam PVC	Gloss	3mm	1220mm X 1220mm	2.122 KG
68008	Premium Cladding Sheet - Foam PVC	Gloss	3mm	1220mm X 2440mm	4.244 KG
69008	Premium Cladding Sheet - Solid PVC	Satin	2.25mm	1220mm X 2440mm	9.511 KG

Fixing Accessories

These are all 3m long, and made from extruded PVC.

- 76130, H-Section Division Bar



- 76134, H-Section Top Cap & Base

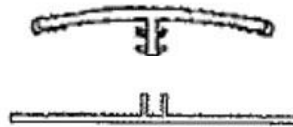

- 76131, J-Section Capping Strip



- 76133, F-Section External Corner

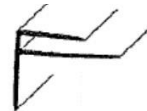

- 76132, C-Section Internal Corner

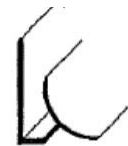

Installation checklist

- Ensure walls are smooth, level, dry, clean and free from dust.
- Ensure power points, electrical switches, plumbing pipework etc. are all finished.
- First, plan and measure where the cladding will go. It is often easiest to start installation at an internal corner.
- Never install cladding near hot areas as this could distort the sheets.
- Ideally, use sheets from the same production batch, and in the same orientation, for each project.
- Store cladding for 24 hours at a similar temperature to the destination room temperature.

Cutting

Use a craft knife or a saw with a sharp blade designed for cutting wood or plastic. This gives a cleaner result than fine tooth metal saws. Sheets at room temperature are easier to cut.

Adhesives

The recommended adhesive for installing PVC Cladding sheet is Polyurethane (PU), to be applied to the back of the cladding sheet. In most situations, one 300ml cartridge of PU adhesive per 8' x 4' sheet is sufficient.

Installation

- 1) Use the J-Sections to frame the top and bottom edges of the sheets. Screw the J-Section to the wall as shown, over beads of silicone. Apply adhesive to the back of the sheet and apply a bead of silicone to the inside of the J-Section to make a watertight seal with the sheet. The silicone seal is especially important at the base, where wet cleaning may occur. Drop the first sheet in to the bottom J-Section and flex it into the top J-Section, leaving a couple of mm clearance inside the profiles for thermal expansion.

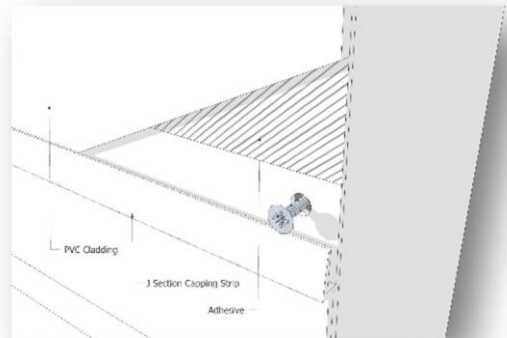

- 2) If using a one part H-Section, apply a bead of silicone to the inside of the profile, then slide the H-Section onto the sheet's vertical edge. Leave a 23mm expansion gap inside the profile. Screw the H-Section to the wall as shown. Continue with the next sheet along by dropping it into the bottom J-Section, flexing it into the top J-Section, and sliding the sheet sideways to the H-Section. Ease the sheet into the H-Section starting at the bottom and working up the sheet, at a slight angle.

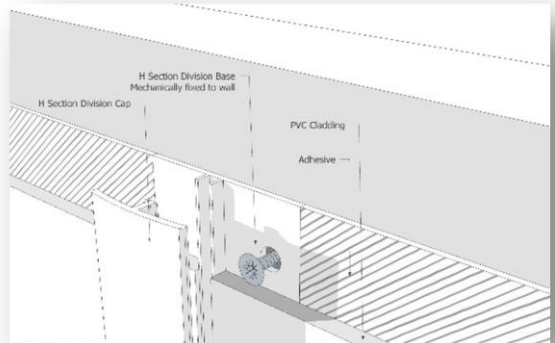
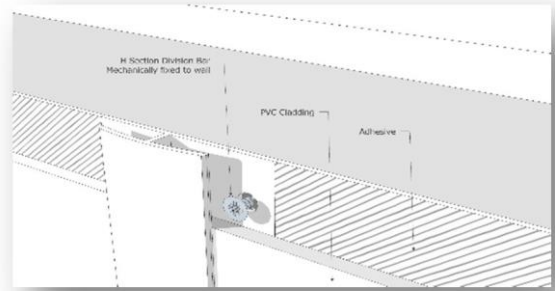

- 3) If using a two part H-Section, apply a bead of silicone to the inside of the profile, then slide the H-Section base behind the sheet. Leave a 2-3mm expansion gap between the edge of the sheet and the central fin of the base, and screw the base to the wall as shown. Continue with the next sheet along by dropping it into the bottom J-Section, flexing it into the top J-Section, and sliding the sheet sideways to the H-Section. Once all sheets are in position, press to click the H-section top caps in place.

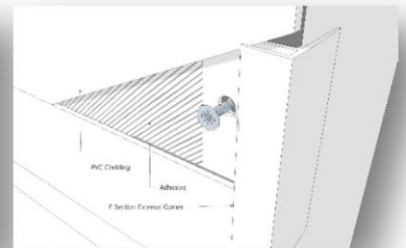
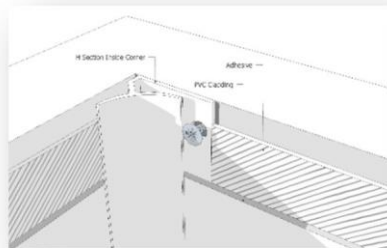

- 4) Use Inside Corner C-Profiles and External Corner F-Profiles where walls come together to form an angle. Screw the profile to the wall, use sealant, slide sheets in and leave a 2-3mm expansion gap in a similar way to the H-Sections.
Remove the protective film from sheets after installation is complete.